

EVER & EVER™

RECESSED



LEDOLOGY®

WWW.LEDOLOGY.COM

EVER & EVER™

WALL RECESSED

TYPE:

PROJECT NAME:

L.4503

MODEL #

LENGTH

DIRECT

OPTIC

VOLTAGE

FINISH

L.4503	PRODUCT PHOTO	LENGTH
		<p>02: </p> <p>04: </p> <p>08: </p> <p>Contact us for other lengths.</p>

Features

- 1 1/2-inch-wide aluminum extruded profile.
- Extruded aluminum profile ensuring perfect product integrity combined with die-cast end caps for a clean and minimalist final product.
- Available with LED light source.
- Available in three standard lengths: 2', 4' and 8'.

PRODUCT DATA

DIMENSIONS	LAMPING OPTIONS	FIXTURE INFORMATION
<p>Electronic driver</p> <p>18 in BX cable W/ Connection box</p> <p>LED driver & wiring conduit</p> <p>Mounting bracket</p> <p>LED</p> <p>Optional optics</p>	<p>7,5W White LED (per foot)</p>	<p>02': </p> <p>04': </p> <p>08': </p> <p>Length given from flange to flange All fixtures are supplied with 18" BX cable and a connection box at one end</p>

SPECIFICATION SHEET

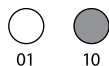

LEDOLOGY®

WWW.LEDOLOGY.COM

EVER & EVER™
WALL RECESSED

TYPE:

PROJECT NAME:

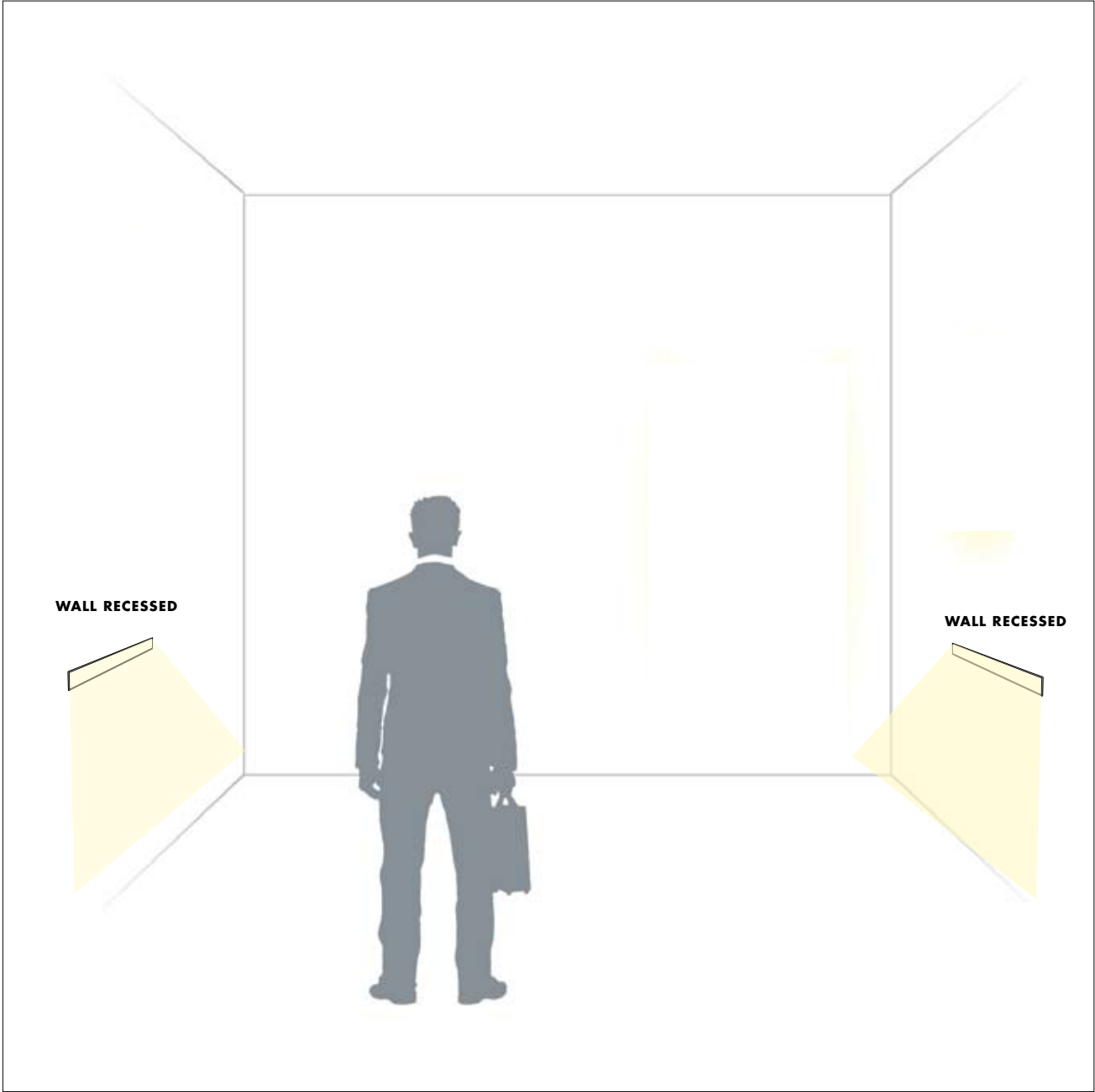

SPECIFICATION SHEET

EVER & EVER™
WALL RECESSED

TYPE:

PROJECT NAME:

LAMPING	OPTIC	VOLTAGE	FINISH
<div>LD3: White LED 3000 K</div> <div><div></div></div> <div>LD4: White LED 4000 K</div> <div><div></div></div>	<div>FD: Frosted Diffuser</div>	<div>120: 120 volts</div> <div>For LED version only</div>	<div>01: White</div> <div></div> <div>10: Grey</div> <div></div> <div>Contact us for custom colors.</div>

L.4503	-	-	-	-	-
MODEL #	LENGTH	DIRECT	OPTIC	VOLTAGE	FINISH

The EVER and EVER Series are offered with a choice of 3 different optic options including a clear diffuser for indirect lighting application ensuring dust protection, a frosted diffuser for Direct, Indirect or Direct/Indirect applications providing a soft non glary distribution and our proprietary Dark Light Louver where controlled light distribution and irridescence control is required.



CLEAR DIFFUSER

Made of extruded PMMA acrylic, the Snap-in-Place clear diffuser is intended to be used as a dust cover for Indirect configurations.

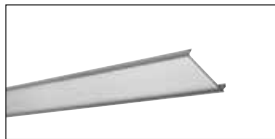

FORSTED DIFFUSER

Made of extruded PMMA acrylic with a proprietary frosting technique. The frosted diffuser is intended to be used in Direct, Indirect or Direct/Indirect lighting distributions for both the Pendant and Wall Series. The Frosted Diffuser is standard on the Series to ensure the desired halo lighting effect.

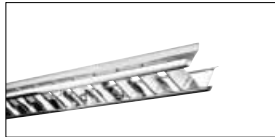

DARKLIGHT LOUVER

The unique Darklight Louver is made out of a specular aluminum material with a deep T5 parabolic louver design increasing the downward efficiency while providing a glare-free illumination.

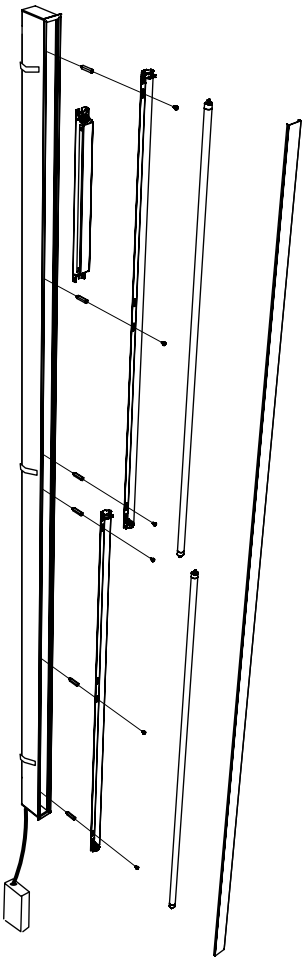

SPECIFICATION SHEET